

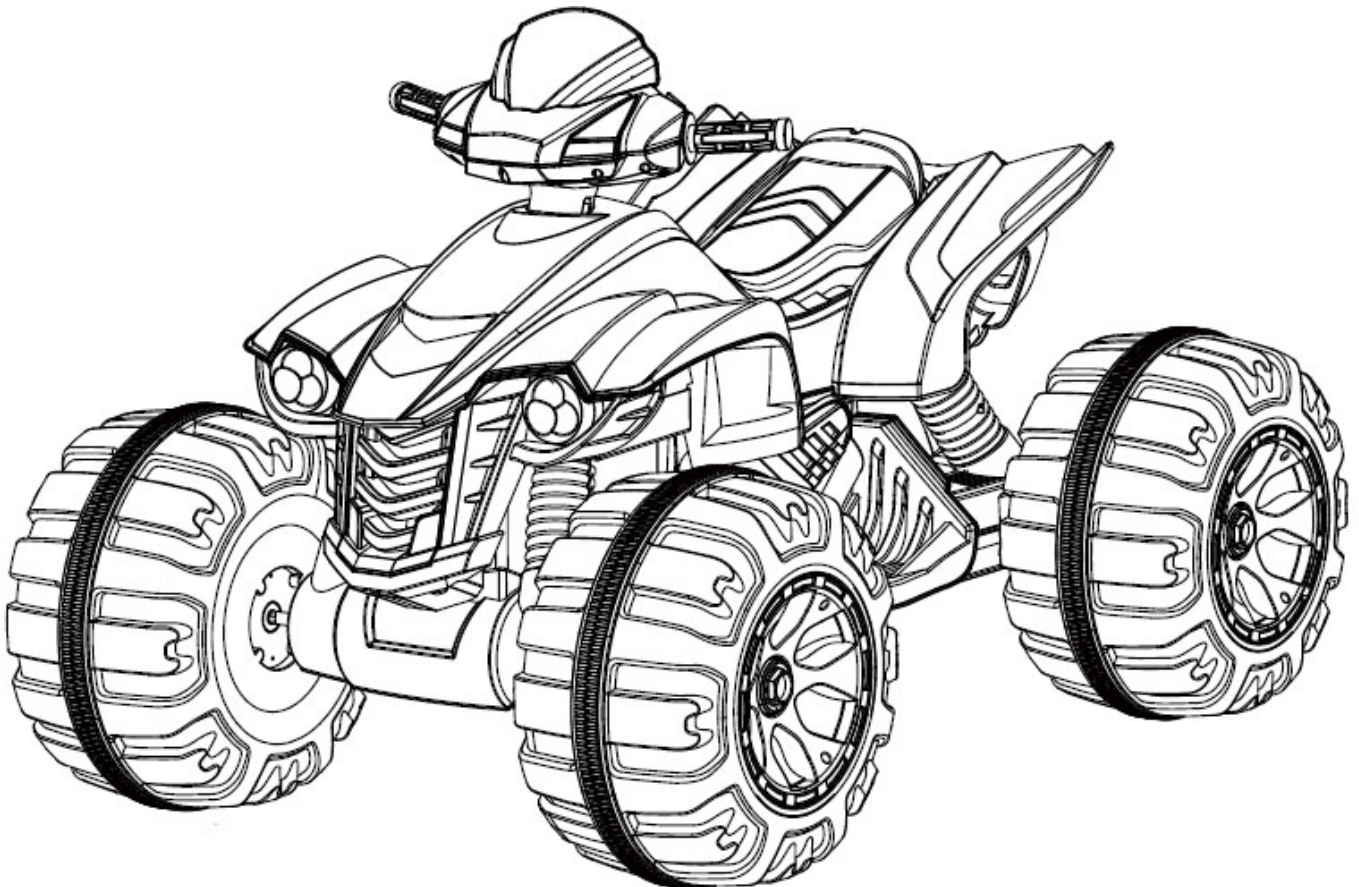

OPERATION MANUAL
BATTERY-POWERED ELECTRIC VEHICLE



MODEL: DBX-ATV QUAD

www.crooza.de



Not recommended for children under 3 years – Small parts may be inhaled or swallowed.

The vehicle must be operated only under adult supervision!

This vehicle is not allowed to be used as a means of transportation and cannot be operated in public streets!

WARNING: Never leave charging unattended!

Read this manual carefully before the operation.

You can find the instructions and pictures on our Website: www.crooza.de

ELECTRIC SHOCK



WARNING

- Unfixed batteries may fall off the overturned vehicle and cause injuries. Ensure that the batteries have been fixed carefully.

• FIRE PREVENTION

- The electric system of the vehicle is not allowed to be altered. Alterations may lead to fire, black-out of the electric systems and serious injuries.
- Using wrong batteries and chargers may lead to fire, explosion and serious injuries.
- Only adults are allowed to handle batteries. The batteries, which are quite heavy, are filled with electrolyte. Leaking batteries may lead to serious injuries.
- Do not let your children to charge the batteries. Only adults are allowed to charge the batteries. **Only adults are allowed to charge the batteries and the charging process must be supervised continuously.** Children may get injured by an electric shock.
- Please check the batteries, cable connections and the connector of the charger before charging the batteries. If you find any defects, do not charge them until they are repaired by an expert.
- The motors produce HEAT! Be careful during the contact with the motors.

SAFE DRIVING



WARNING

PREVENTING INJURIES

- The vehicle must be operated only under adult supervision!
- Never use the vehicle in darkness!
- Operation only on safe grounds!

E.g: In areas

- without swimming pools or ponds. Risk of drowning!
- without slopes.
- far from stairs, handrails, streets and boulevards.

- Operating Directives

Ensure that the following rules are followed for a safe operation:

- Always sitting properly on the seat.
- No driving without sturdy shoes.

ATTENTION!



WARNING

- Small items are included in the package at delivery status. Assembling must be conducted under adult supervision. Children may swallow the small items. Risk of choking.
- The charger must be used only in a dry environment.



WARNING

The charger must be used only in a dry environment.

- If the fuse blows out, the charger must be changed. In order to avoid repeated operational disruptions, ensure that the vehicle doesn't carry more than 40 kg. Avoid unfavorable conditions such as slopes or solid objects like walls. Otherwise, the wheels may stand still and the motors may get overcharged. Teach your child to keep the vehicle still before changing the direction.
- If the fuse doesn't comply with the normal operational conditions, contact your service.
- Before the first operation, the batteries must be charged at least 14 hours.
- The charging time mustn't exceed 16 hours once.
- While being charged, the batteries must stand vertical.
- The charger is not a toy and not suitable for children.
- The batteries mustn't be short-circuited.
- Charging through contaminated socket can lead to short-circuit and other defects. Therefore, it must be refrained.
- The charging process must be carried out safely, FAR from easily inflammable materials. Look out excessive smoke and heat generation.
- **The charging process must be conducted continuously under adult supervision!**

SECURITY CHECK BEFORE THE FIRST OPERATION

Pay attention to unusual sounds like loose parts or broken components during the operation. If you are unsure, please consult an experienced mechanic.

! THIS OPERATION MANUAL CONTAINS IMPORTANT INSTRUCTIONS FOR A SAFE OPERATION OF THE VEHICLE.

IMPORTANT MESSAGE FOR PARENTS: READ THE WHOLE MANUAL CAREFULLY BEFORE OPERATING THE VEHICLE AND FOLLOW THE INSTRUCTIONS.

The guarantee for a safe operation lies behind the parents' responsibility. Parents must ensure that they have read all the warnings and security instructions, which will be then explained to children so as to follow. Parents are also responsible for whether the child is ready mentally and physically to operate the vehicle according to the conditions. It is recommended to go through the operating instructions periodically together with the young drivers and to examine the vehicle for possible defects and to carry out the regular maintenances.

Whether a child is ready to operate this vehicle depends on different factors like body height, intellectual standard, build etc. If the child has problems with operating the vehicle, do not let him drive it.

Safety Instructions

1. **The vehicle mustn't be used as a means of transportation! In order to prevent risks, it mustn't be operated in public streets, highways, rock pools, river beds etc.**
2. **RISK OF CHOKING!** After unpacking, dispose the package immediately. The package is not a toy; children mustn't be allowed to play with it.
3. Removable parts of the vehicle mustn't be swallowed or played with. Supervise your children while they are driving the vehicle.
4. The vehicle is for children under 40 kg. Do not overload the vehicle.
5. During the operation, do not touch the wheels or the parts of the wheel.
6. Electric cables and components mustn't be modified. Maintenance and reparation must be conducted by a professional expert.
7. Do not clean the vehicle with water. Use a soft wet cloth for cleaning.
8. Prefer flat areas and fixed grounds.
9. If the vehicle won't be operated for a long time, the batteries must be taken off. Keep the batteries in a cool and dry place. Keep the batteries away from heat and fire. Charging batteries once 4 weeks regularly extends the battery life.
10. Recharging the batteries as soon as the speed decreases extends their life.
11. Avoid short-circuit of cable ends.
12. Do not use the vehicle in rainy weather or on a wet ground.
13. Use the specified fuses only.

Technical Data

Item no	DBX-ATV QUAD
Age properly	3-8 years old
Vehicle Size	120 x 82 x 77 cm
Net weight	20 kg
Max. Loading	35 kg
Environment temperature	0-40 °C
Speed	approx. 4-8 km/h
Battery	1 x 12V10AH
Charger	Input: AC220V~240V/50Hz~60Hz, Output: DC12V 1000mAh
Motors	2 x 12V Motors
Charging lifetime	approx. 300
Charging time	8-12 hours, never more than 18 hours once.

Package Content

Nr.	Item	Amount	Notes
1	Handle unit	1	
2	Main body	1	
3	Front axle	1	
4	Seat	1	
5	M5x45 Screw	1	On the handle unit
6	Ø5 Screw nut	1	On the handle unit
7	Ø12 Washer	6	4 pieces for the front axle 2 pieces for the front axle
8	Steering rod	1	
9	Front wheel	2	
10	Rear wheel	2	
11	Ø10 Lock nut	1	
12	Rear axle	1	
13	Charger	1	

Content of the Assembly Packet			
A	Ø4x12 Screw	9	1 extra piece
B	M5x12 Screw	1	
C	Splint (Fixing pin)	2	1 extra piece
D	Hub cap	4	
E	Wheel hub sleeve/Spacer	2	
F	Spanner	2	
7	Ø12 Washer	3	1 extra piece

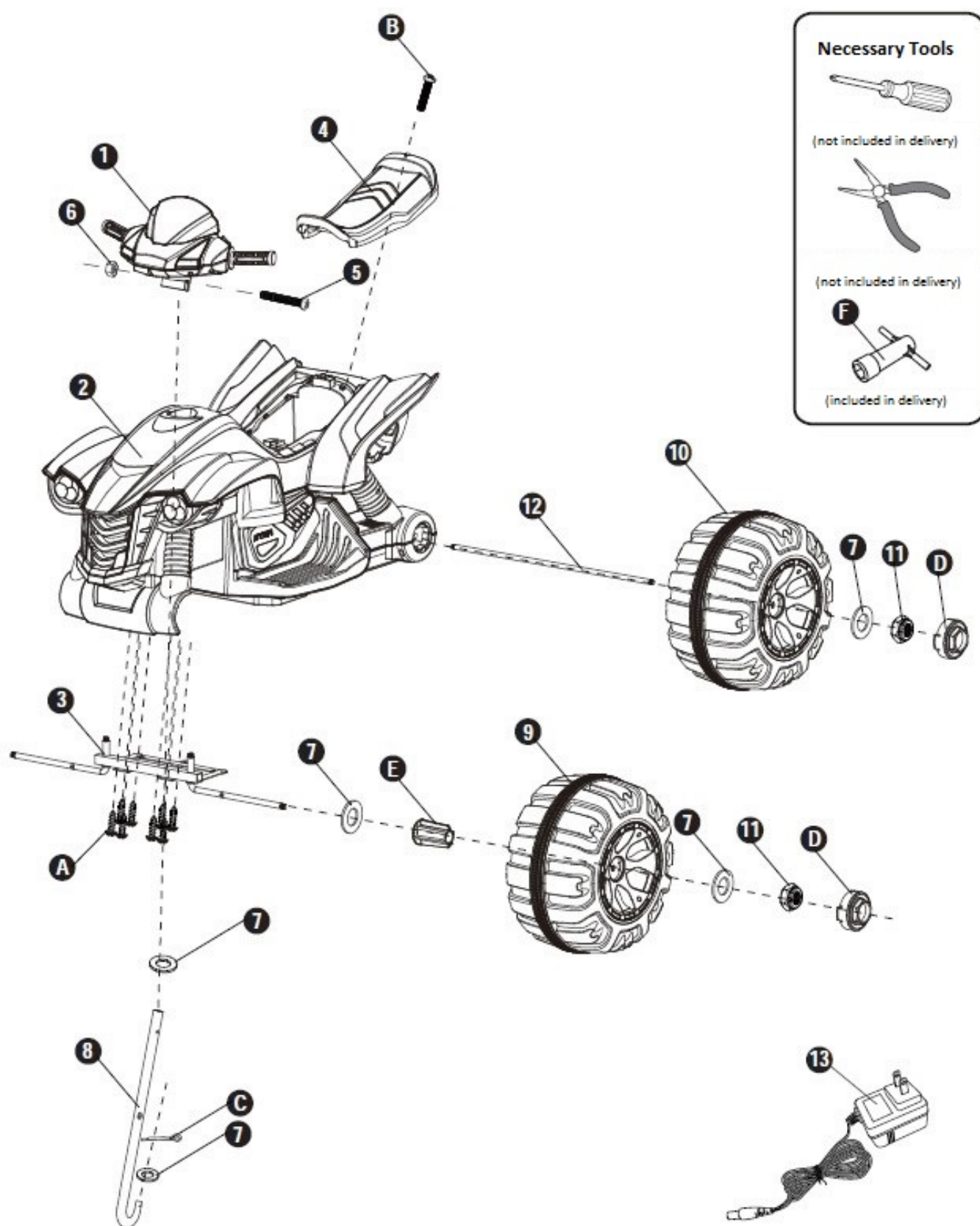

ASSEMBLY INSTRUCTIONS

WARNING!

The vehicle must be assembled only by an adult.

WARNING: At delivery status, the positive pole (red cable) is in bulk for safety reasons. Please attach and stow it **carefully**.

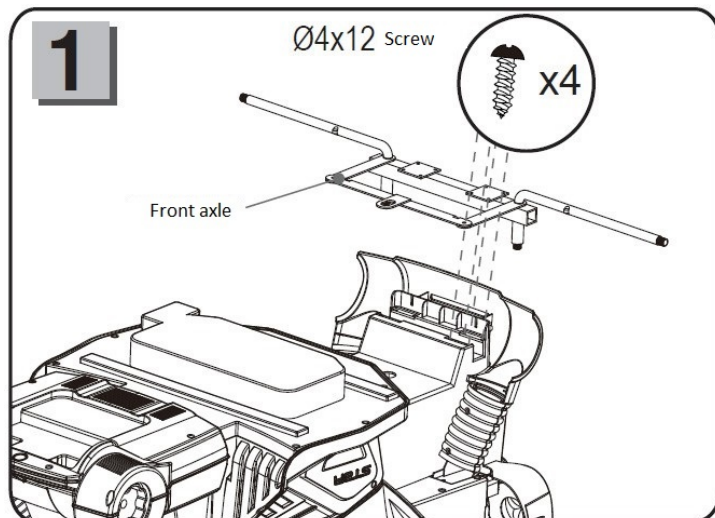

- Lay the vehicle down on its back.
- Put the front axle in its place and fix it with 4 screws M4x12.

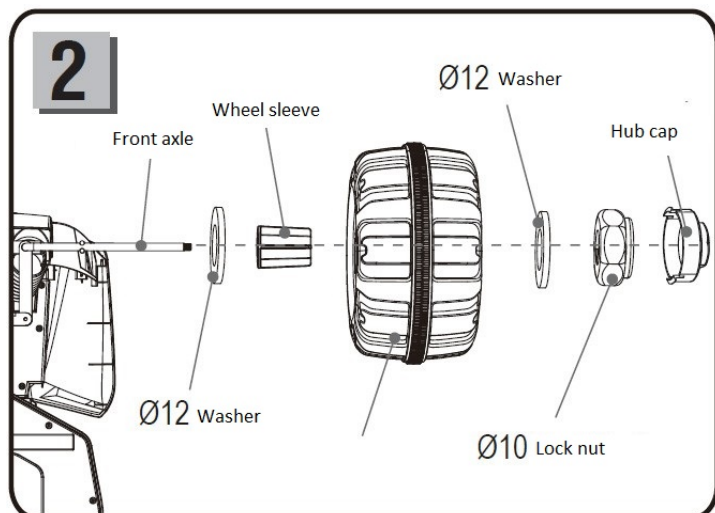

- Remove all the parts of the front axle.
- Place a Ø12 washer on the axle.
- Place a wheel hub sleeve/spacer on the axle.
- Place a front wheel on the axle.
- Place another Ø12 washer.
- Take a Ø10 screw nut and screw the wheel with the spanner (F) firmly. **Do not screw the nut TOO FIRMLY! The wheel must be able to spin freely.**
- Complete the process with a wheel hub cap and repeat everything on the other side.

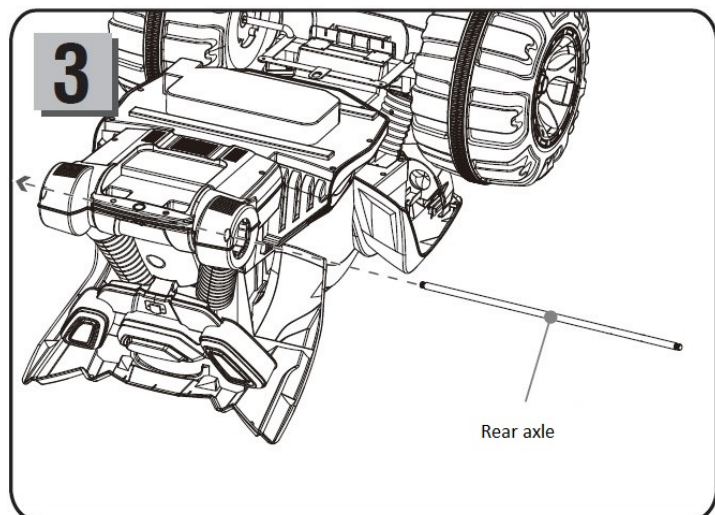

- Remove all the parts of the rear axle.
- Position the rear axle through the opening on the main body, as shown in Fig.4.

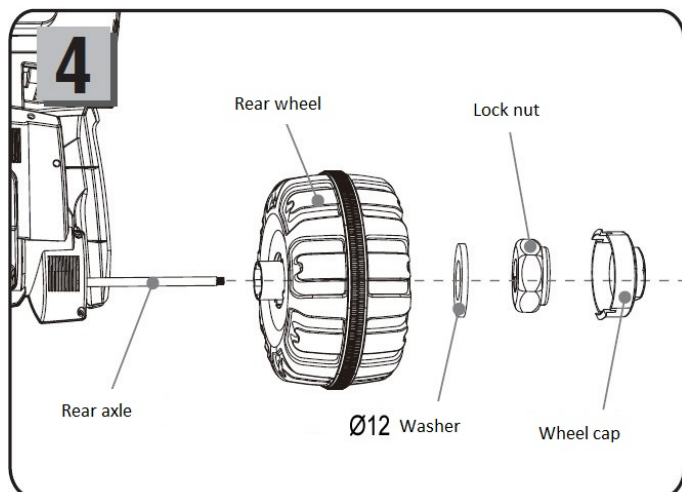

- Place a rear wheel on the axle.
- Place a Ø12 washer.
- Take a Ø10 screw nut and screw the wheel with the spanner (F) firmly. **Do not screw the nut TOO FIRMLY! The wheel must be able to spin freely.**
- Complete the process with a wheel hub cap and repeat everything on the other side.

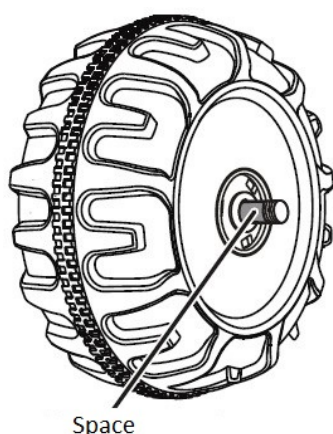

IMPORTANT!

Check the space between the wheel and the screw nut after every wheel assembly. If the space is too much, take another washer and reduce the space. Ensure that the wheel spins freely after reducing the space.

If the wheels don't spin freely, this may lead to an overload of the motors and the defects inside the gearbox.

If the space is too little, remove some washers to ensure that the wheel spins freely.

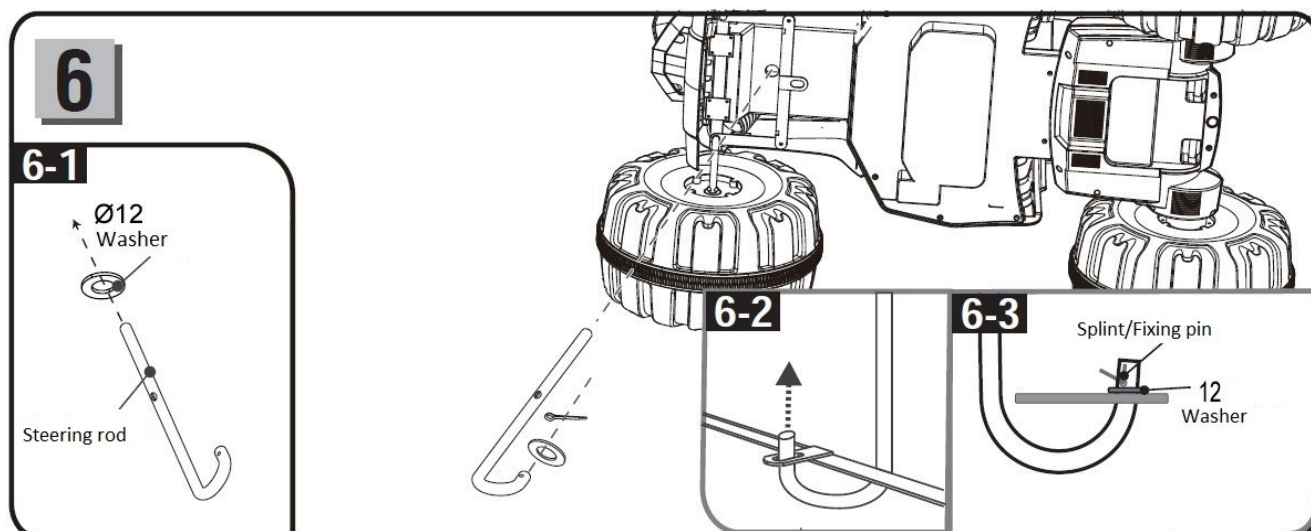

- Lift the vehicle and position it on its side.
- Insert the straight side of the steering rod through the opening on the main body (Fig. 6).
- Insert the bent side through the opening (Fig. 6-2) on the front axle and fix it with a Ø12 washer and a splint/fixing pin (Fig. 6-3).

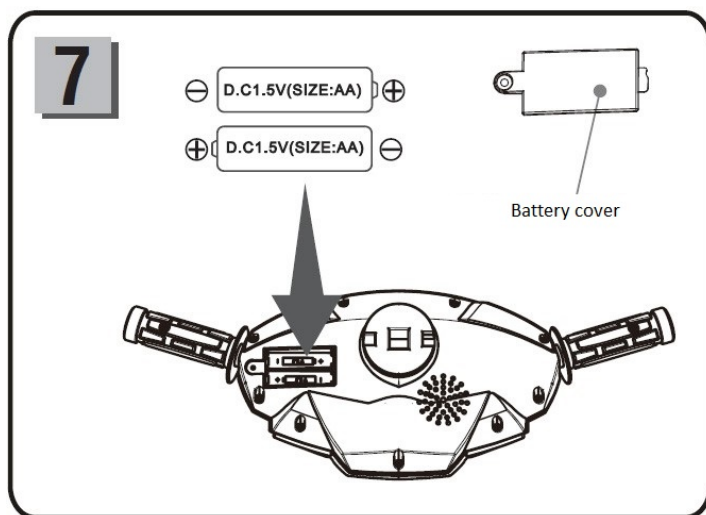

- Unscrew the battery cover and open it.
- Place two 'AA' (LR6) batteries.
- Close the battery cover and screw it again.

IMPORTANT: 'AA' (LR6) batteries are not included in the delivery package.

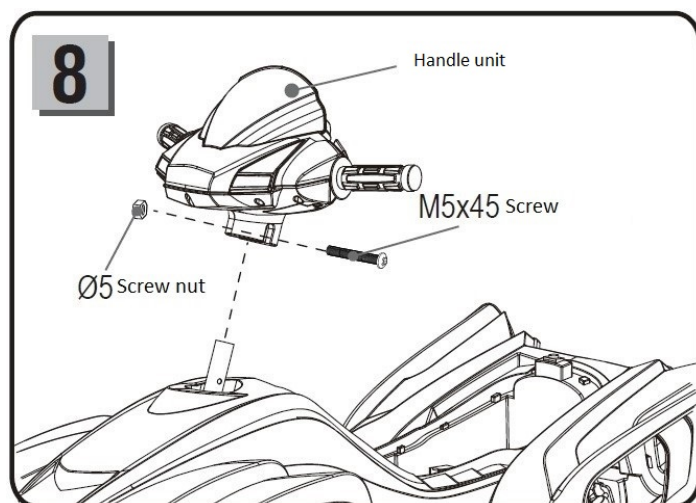

- Turn the vehicle and put it on its wheels.
- Remove the M5x45 screw and the Ø5 screw nut of the handle unit.
- Place the handle unit on the steering rod and screw it with the removed M5x45 screw and Ø5 screw nut firmly.

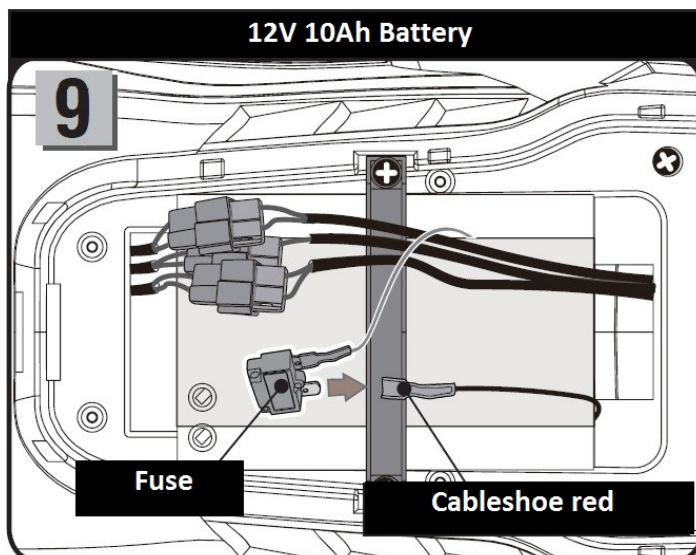

The vehicle will be delivered with unattached cables due to safety reasons.

- In order to provide power, place the red cable under the seat and connect it to the unoccupied pins of the fuse (Fig. 9).

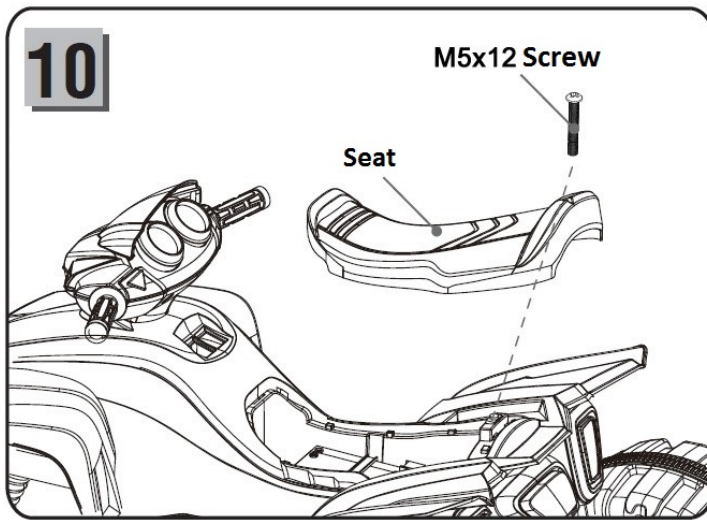

- Let the seat click into its place and fix it with M5x12 screw.

SWITCH ASSIGNMENT AND SWITCH FUNCTIONS

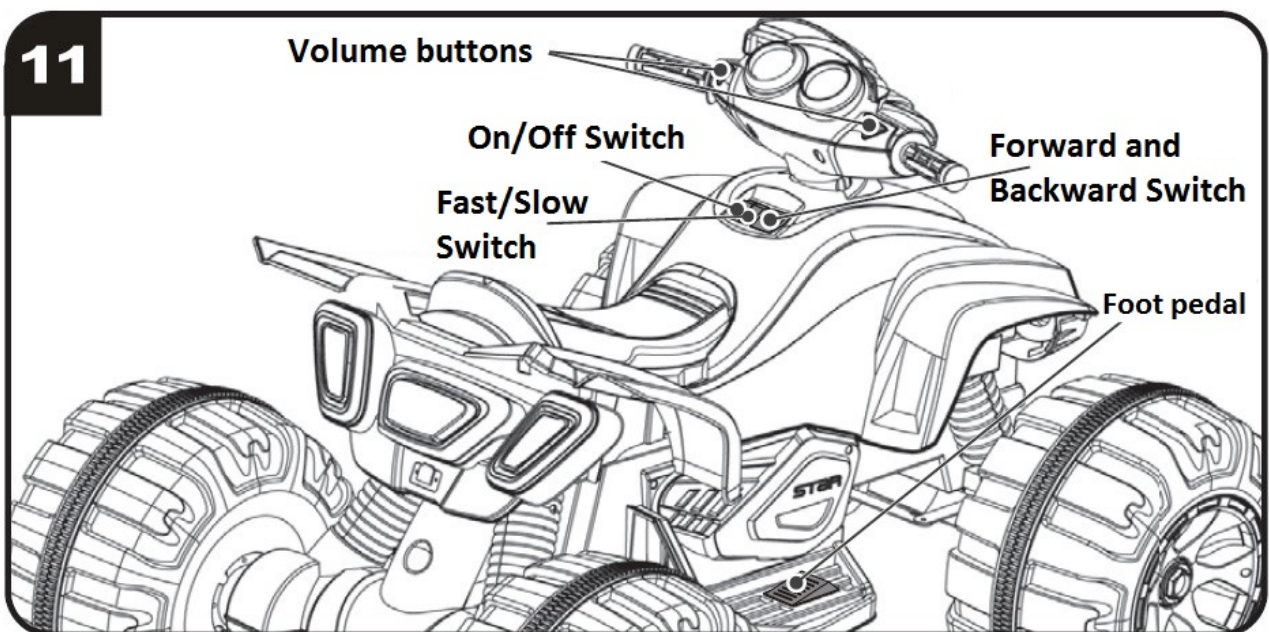

DRIVING FORWARD

1. Bring the Forward/Backward switch on 'Forward'.
2. When the gas pedal is stepped, the vehicle moves forward.

STOPPING/SLOWING DOWN

As soon as the foot pedal is disengaged, the vehicle stops automatically.

DRIVING BACKWARD

1. Bring the Forward/Backward switch on 'Backward'.
2. When the gas pedal is stepped, the vehicle moves backward.

VOLUME BUTTONS

When the volume buttons on the handle unit are pressed, various sounds and music (for children) are heard.

FAST/SLOW SWITCH (HighSpeed/LowSpeed Switch)

This switch determines the HighSpeed and LowSpeed modes of the vehicle (Driving fast or slowly).

IMPORTANT!

In order to avoid damages on the gearbox, the vehicle must be stopped before changing the direction!
During the operation, the direction switch must never be pressed!

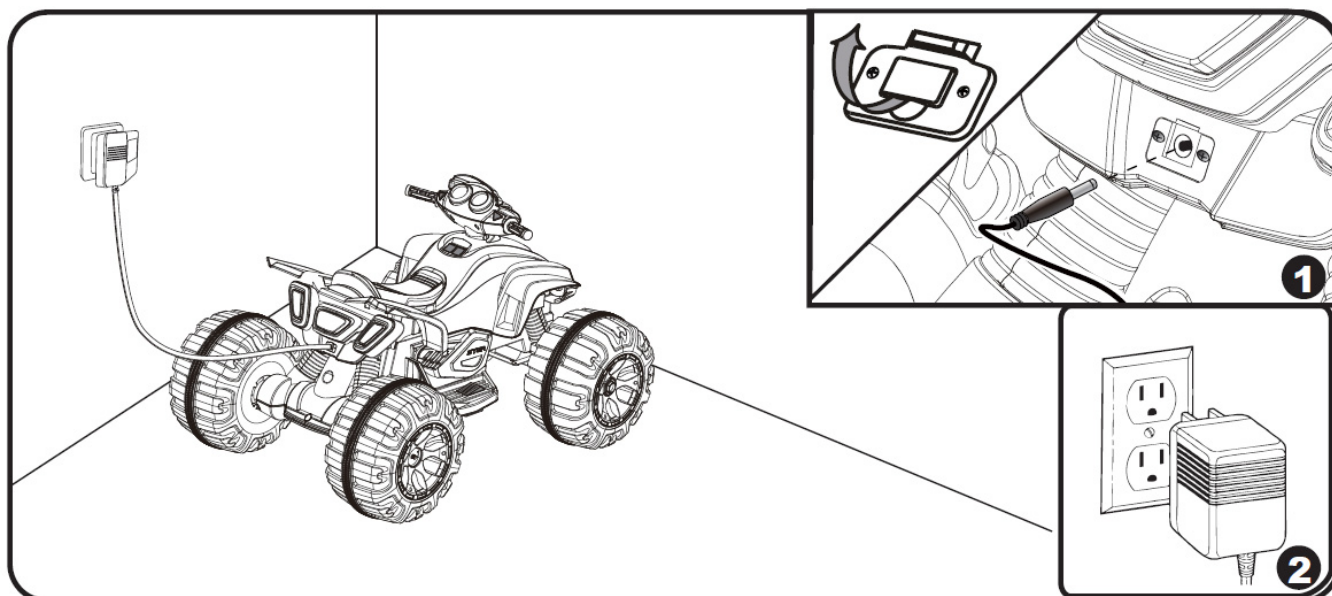

1. Open the cover of the charging jack on the back side of the vehicle (under the rear lamps).
2. Attach the charger to the vehicle and insert it into the socket.

WARNING!

The charging process must be conducted continuously under adult supervision!

All the functions of the vehicle are deactivated during the charging process.

INFO: For a more detailed, step by step manual, visit our Website

www.crooza.de



- The vehicle has a break system, by means of which the vehicle stops automatically as soon as the foot pedal is disengaged.

IMPORTANT!

Practise on steering with your child. Show him/her by which speed the handle unit must/can be turned and how to stop the vehicle.

WARNING:

Driving direction mustn't be changed during the operation to ensure safety and to avoid damages on the gearbox.

ATTENTION!

The vehicle must be operated **ONLY** outdoors.

A big part of floor coverings, which have been misplaced, can be damaged by the vehicle.

The manufacturer is not responsible for the damages occurring on floor coverings.



GENERAL WARNINGS

The operation of the vehicle can lead to dangerous situations. Electrically powered vehicles can move automatically, which may cause dangerous situations. Therefore, it's possible that the control of the vehicle may be lost during the operation, and this may lead to injuries or even death.

LIKE EVERY MOBILE PRODUCT, THE OPERATION OF THE VEHICLE CAN LEAD TO INJURIES OR DEATH EVEN IF ALL THE SAFETY RULES ARE OBEYED AND SAFETY EQUIPMENTS ARE APPLIED. THE OPERATION OF THE VEHICLE IS AT USER'S OWN RISK AND PURSUANT TO COMMON SENSE!

Please follow the local laws and regulations. The vehicle is not a means of transportation and is not allowed to be operated in public streets and on pavements. It is important that no skaters, bicyclists, other children, animals etc. cross the vehicle way. The rights of others using a specific area must be taken into account and respected.

The vehicle has been designed to be operated on straight, clean, dry and flat surfaces, and shows the best performance when the given conditions are fulfilled. The operation on uneven, rough and slippery surfaces can lead to the loss of traction control or undesirable high speeds (at inclinations) and consequently dangerous situations. High speeds like downhill driving must be refrained.

Functional measures such as wearing safety helmets, knee and elbow protectors are significant precautions to prevent injuries.

The vehicle mustn't be loaded with more than 40 kg.

No stunts or tricks must be performed with the vehicle. Improper uses like jumping, sliding etc. must be refrained.

Operations against the common sense or ignoring warnings can lead to injuries or even death.

OPERATION IS AT USER'S RISK. PARENTS ARE RESPONSIBLE FOR THEIR CHILDREN.

Instructions for A Safe Operation

DANGER !



WARNING

PREVENTING INJURIES

- The vehicle must be operated only under adult supervision!
- Never use the vehicle in darkness!
- Operation only on safe grounds!

E.g: In areas

- without swimming pools or ponds. Risk of drowning!
- without slopes.
- far from stairs, handrails, streets and boulevards.

• Operating Directives

- For a safe operation, ensure that these rules are learnt and followed by the children.
- Always sitting properly on the seat.
- Always tight holding
- No driving without shoes.

Explain the instructions below to your child

Right after seeing the vehicle, your child will want to drive it immediately. Children are not capable of judging, realizing and assessing dangers. Unsupervised operations can lead to serious injuries. Before letting your child drive the vehicle, you must check the area and your child's ability to judge and drive the vehicle safely. Even if children are instructed before, they are not capable of foreseeing the dangers and turning away from them. There are no other directly supervision options for adults. Set up safety rules adapted to local conditions alongside the instructions below about using the vehicle. Ensure that these instructions are followed. All of these rules must be obeyed by the children who will play with your child as well.

Directives for a safe operation:

Ensure that children learn and obey the rules below:

1. Always sitting properly on the seat.
2. No driving without sturdy shoes.
3. Maximum two (2) children can get on the vehicle. If children sit improperly or stand in the vehicle, they may fall off; the vehicle may overturn and this may lead to serious injuries.
4. Do not allow your child to drive the vehicle in the streets or roads where motored vehicles are driven.
5. Do not allow your child to drive the vehicle near swimming pools, ponds, barriers (e.g: furniture, trees with low branches etc.) or overhanging building parts (e.g: stairs, wall projections etc.).
6. Never use the vehicle in darkness!
 - An unexpected barrier may cause an accident.
 - Driving only in daylight or well-lit areas.
7. Forbid your child to drive on uneven grounds.
8. Do not allow your child to drive down the stairs.
 - Even if the pedal isn't stepped, it may reach a high and dangerous speed.
 - The vehicle may overturn.
 - The motor may stop suddenly and the vehicle may roll down the stairs together with the child.
9. Moving things must be kept away. Revolving things like motor, gearbox and wheels can jam the fingers, hair etc. and lead to serious injuries. Do not allow your child to operate the vehicle in lateral or over-head position.
10. Do not use any easily inflammable materials near the vehicle. The vehicle has electric switches which spark (like all the switches) when triggered. Easily inflammable liquids can catch fire.
11. Take the batteries off to prevent an unsupervised operation.

Maintenance Instructions

Check if all the screws, screw nuts and protection caps are set correctly and firmly. Ensure that none of the plastic parts are damaged and broken.

In snowy or rainy weather, keep the vehicle in a dry room which has a ceiling. Even if the vehicle won't be used, charge the batteries at least once a month.

The vehicle can be cleaned with a wet cloth. Avoid any contact of water with the electric system of the vehicle.

Contact of water with motor and electric components can lead to corrosion and damage on the motor and the electric components/switches.

Do not use the vehicle on the sand. Sand in the motor, gearbox or electric components causes blockades and blackouts of the related parts.

In order to restore the original gleam of the vehicle, you can work on the plastic parts of the vehicle with a wax free furniture polish. NEVER use a car polish.

For a safe operation, it is recommended that the vehicle is checked regularly by an authorized service point.

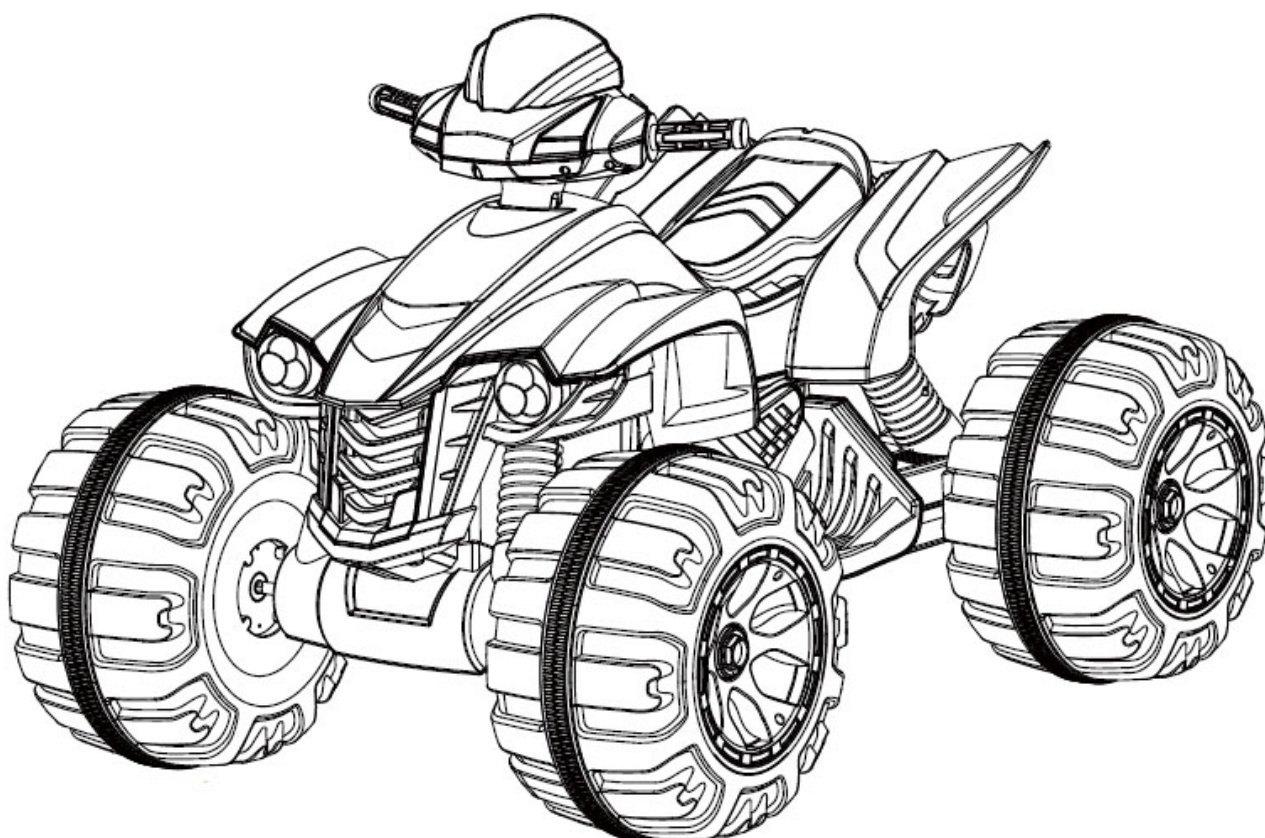

Troubleshooting

Problem	Possible Cause	Solution
No sound, no light, the vehicle doesn't move	<ol style="list-style-type: none"> 1. Cable connections are loose. 2. Check the fuse. 3. Is the main switch ON? 	Check the cable connections. Ensure that the batteries are in their place under the handle unit. Change the fuse. Turn the main switch to ON.
No sound while driving.	Handle unit batteries are not placed correctly. Check if the batteries under the handle unit are placed correctly.	Bring the batteries to the right position or change the batteries.
Although the motor works, the vehicle doesn't move	<ol style="list-style-type: none"> 1. Electric motor is not connected to the gearbox. 2. Tighten the motor screws 3. Check the gearbox. 	Remove the wheels, take the drive system out and tighten the motor screws on the gearbox. When needed, change the gearbox if it chatters and the drive system doesn't turn.
Motor doesn't work	<ol style="list-style-type: none"> 1. Does the gas pedal have contact? Are all the cables set in their place? 2. Is the motor in a proper condition? 3. Is the cable connection of the motor normal? 4. Remove the connector and connect the battery directly with the motor. Then, check if the motor works. 5. Ensure that the switch for the remote control is in the correct position. 	<p>Clean the cable ends.</p> <p>Plug the connector in the right slot.</p> <p>If the motor doesn't work still, it must be changed.</p> <p>If the motor works, check whether the cable connections are correct and firm.</p> <p>Check all the cable connections if they have right contacts and are set correctly.</p>
Forward motion is OK, backward motion doesn't function or backward motion is OK, forward motion doesn't function	<ol style="list-style-type: none"> 1. Probably, a cable connected to ON/OFF switch got loose. 2. Check if the connector of forward/Backward switch is set correctly and has contact. 	<p>Change the Forward/Backward switch.</p> <p>Ensure that the connection is normal.</p> <p>Check all the cables on the switch if they are connected correctly.</p>
Speed is very low	<ol style="list-style-type: none"> 1. Check if the batteries supply more than 6V. 2. Connect the motor (together with the gearbox) directly with the battery and check if the speed increases. 3. Remove the gearbox and check if it is in a good situation. 	<p>Charge the batteries again.</p> <p>The reason for speed loss might be the condition of the ground on which the vehicle is operated.</p> <p>Change the motor and gearbox.</p> <p>Replacement parts can be found at crooza.de</p>
Batteries cannot be charged	<ol style="list-style-type: none"> 1. Check if the output voltage of the charger is between 12-16V 2. Plug the charger, remove the connector from both sides of the battery and check if the battery directly if $7,2 \pm 0,1V$ is supplied. 3. Does the Control-LED of the charger flash up? 	<p>Change the charger.</p> <p>Change the batteries.</p> <p>Ensure that the charger is connected correctly.</p> <p>Check the fuse. Charging is possible only when the fuse is set correctly and the switch is OFF.</p>
Remote control doesn't work	<ol style="list-style-type: none"> 1. Check if the vehicle is in remote control mode. 2. Ensure that the Control-Display of the remote control flashes up. 	<p>Switch the vehicle to remote control mode.</p> <p>Check the plug connections.</p> <p>Check the batteries of the remote control.</p>

Suitable original replacement parts can be found at www.crooza.de

Instructions Related to the Maintenance and Disposal of the Batteries and the Vehicle

MAINTENANCE

If a battery is leaky, remove the battery which has acid escaping by avoiding skin contact and put the battery in a plastic bag. Please check the description on the right side to learn how the battery can be disposed in the right way.

In the event of skin or eye contact, rinse the affected part in running water for at least 15 minutes and see a doctor.

When acid is swallowed, water, milk etc. must be drunk or egg white eaten immediately. Never try to throw up. Call the doctor instantly.

Before the first operation, the batteries must be charged with the help of the provided charger for at least 14 hours once. Never charge the batteries longer than 16 hours once. Overloading and excessive discharge shorten the battery life and operating period substantially.

Before every operation, the batteries must be charged approximately 14 hours. Charge the batteries after every operation, no matter how long the vehicle was operated.

The batteries must stand vertical while being charged. Do not discharge the batteries completely before charging them again.

Charge the batteries for a long time before putting the vehicle away.

Even if the vehicle won't be used, charge the batteries at least once a month.

Batteries left empty will definitely stop working later. Never leave leaking batteries in the vehicle. Leaking liquid can damage the vehicle.

Do not keep the batteries on the surfaces like the countertops in kitchens; they may get damaged. Take precautions to protect the contact surface before you put the batteries down.

Do not keep the batteries in a place where the temperature is above 24 °C and below 0°C.

Only use 6V batteries. Do not forget to charge the batteries for approx. 14 hours before the first operation.

Ensure that the batteries are not loose in the vehicle.

Always use a battery fastener to lock the batteries.

Check the batteries and the charger against imperfections and defects before every charging. If you detect a defect, do not charge the batteries until the defected part is repaired.

DISPOSAL

The provided battery is overflow-protected and welded. It must be ecologically disposed and recycled.

Do not throw the battery into fire. It may leak or explode.

Do not dispose the batteries together with normal domestic waste. **Disposing the batteries with normal domestic waste is prohibited by law!**

Protect the environment by not disposing the batteries with normal domestic waste (2202/96/EC). Get information about recycling and disposing options from the local administration in your vicinity.



Pb Cd Hg

**Batteries separately disposed
(not with domestic waste!)**

**Do not throw the battery into fire!
Don't open!**

The symbol „crossed-out waste container“ on the product and in the manual indicates that electric and electronic devices must be collected and disposed separately from normal domestic waste.

There are various collection systems about recovery and recycling available in the EU.

For more information, please consult your local authorities or your dealer.



IMPORTANT!!! OPERATION ONLY UNDER ADULT SUPERVISION!

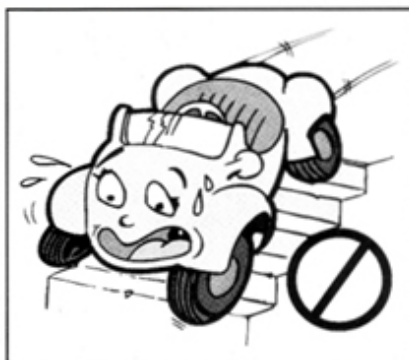

NO DRIVING IN DANGEROUS PLACES SUCH AS PUBLIC STREETS, STAIRS, SWIMMING POOLS, PONDS ETC.



BEFORE OPERATING, ENSURE THAT THERE ARE NO PEOPLE, PETS OR OBJECTS IN THE WAY.



ALWAYS FOLLOW THE DIRECTION.



BRAKING ON TIME TO PREVENT INJURIES.

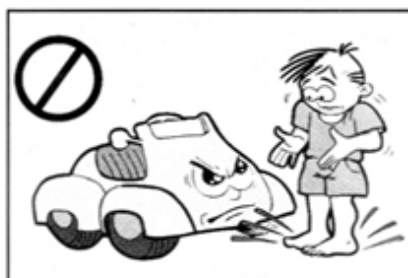

NO DRIVING WITHOUT STURDY SHOES.

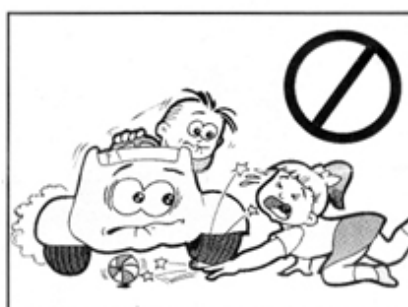

DO NOT BRING BODY PARTS, DRESSES OR OTHER OBJECTS NEAR THE MOVING VEHICLE AND THE WHEELS.



THE VEHICLE, CABLE CONNECTIONS, MOTOR AND BATTERIES MUST BE KEPT AWAY FROM WATER. DO NOT WASH THE VEHICLE WITH A WATER HOSE.



CLEAN THE VEHICLE WITH A WET CLOTH. ONLY ADULTS MUST CLEAN THE VEHICLE.

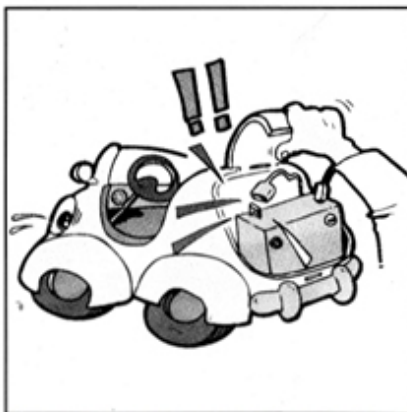

CHECK THE ELECTRIC SYSTEM, CABLE CONNECTIONS AND BATTERIES REGULARLY. IF YOU DETECT A DEFECT, DO NOT USE IT UNTIL IT IS REPAIRED BY A REPAIRMAN.

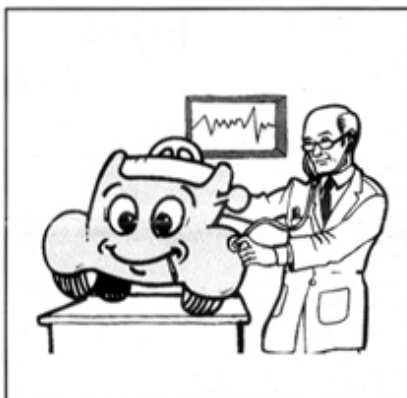

CHECK THE ELECTRIC SYSTEM, CABLE CONNECTIONS AND BATTERIES REGULARLY. IF YOU DETECT A DEFECT, DO NOT USE IT UNTIL IT IS REPAIRED BY A REPAIRMAN.



THE CHARGER IS NOT A TOY AND MUST BE KEPT AWAY FROM CHILDREN! FIND A PLACE THAT CHILDREN CANNOT REACH AND DO NOT LET YOUR CHILDREN CHARGE THE VEHICLE.



CHECK THE CHARGER AND DO NOT PLAY WITH IT. IF YOU DETECT A DEFECT, REPLACE IT. ONLY USE THE CHARGER THAT DUBAX-MARKETING PROVIDES.

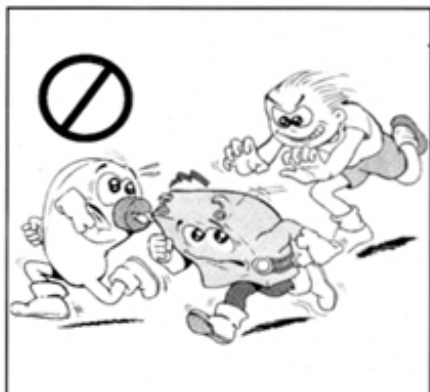

WARNING: CHARGE THE BATTERIES BEFORE THE FIRST OPERATION. DO NOT ALLOW CHILDREN TO TOUCH THE BATTERIES AND THE CHARGER. CHARGING MUST BE CONDUCTED BY ADULTS.



ONLY USE THE BATTERIES THAT DUBAX-MARKETING PROVIDES.

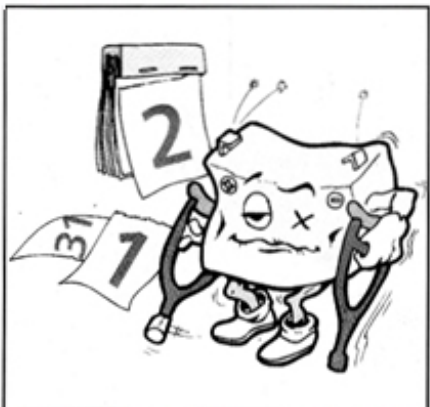

CHARGE THE LOW BATTERIES AGAIN. IN ORDER TO PREVENT DEFECTS ON THE BATTERIES, NEVER DISCHARGE THEM COMPLETELY.



IF THE VEHICLE WON'T BE OPERATED FOR A LONG TIME, CHARGE THE BATTERIES AND DISCONNECT THE BATTERY PLUG FROM THE VEHICLE. THEN, THE BATTERIES MUST BE CHARGED ONCE TWO MONTHS AT THE LATEST, IF YOU WON'T USE IT IN THE MEANTIME.

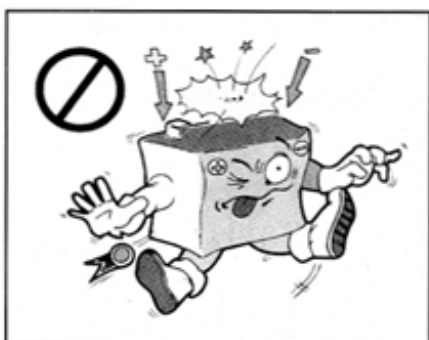

PAY ATTENTION TO THE RIGHT POLARITY(+/-) OF THE BATTERY.

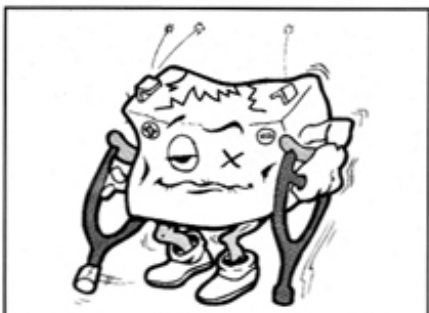

CHECK THE BATTERIES REGULARLY. DO NOT EXPOSE THEM TO PRESSURE. IF YOU DETECT A DEFECT, REPLACE THEM IMMEDIATELY.



NEVER OPEN THE BATTERIES. THEY INCLUDE LEAD AND CORROSIVE ACID. WHEN THERE IS A SKIN CONTACT OR SWALLOW, THEY MAY LEAD TO CORROSION AND SERIOUS INJURIES.

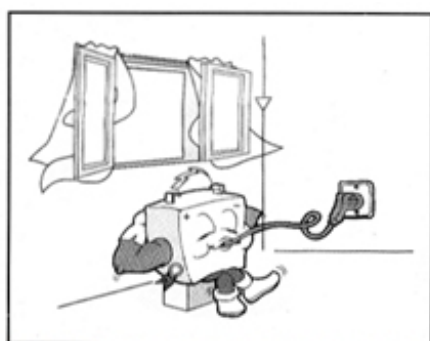

DURING THE CHARGING PROCESS, EXPLOSIVE GASES MAY COME INTO EXISTENCE. CHARGE THE BATTERIES ONLY IN A WELL AIR CONDITIONED ROOM AND KEEP THEM AWAY FROM INFLAMMABLE MATERIALS.

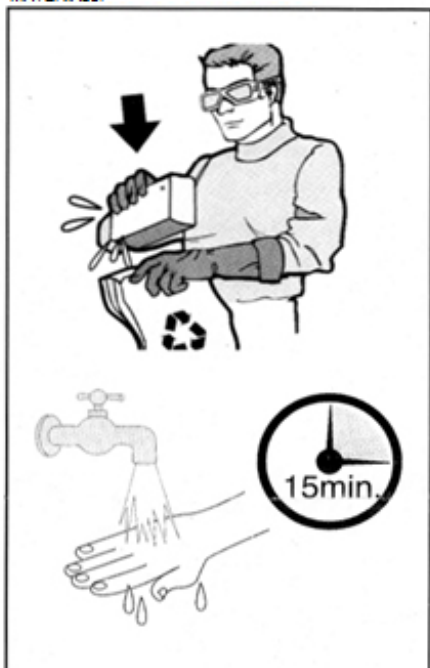

IF THE BATTERY LEAKS, AVOID SKIN AND EYE CONTACT WITH THE LIQUID OF THE BATTERY AND PUT THE BATTERY IN A PLASTIC BAG. PLEASE READ THE INSTRUCTIONS IN THE OPERATION MANUAL IN ORDER TO LEARN HOW TO DISPOSE THE BATTERY.

IF THERE IS A CONTACT (SKIN OR CLOTHES) WITH THE LIQUID OF THE BATTERY, PUT THE RELATED PLACE UNDER WATER FOR AT LEAST 15 MINUTES AND CONTACT THE DOCTOR.

IF THE LIQUID OF THE BATTERY IS SWALLOWED, DRINK A LOT OF WATER, OR MILK OR EAT EGG WHITE. DO NOT TRY TO THROW UP AND LOOK FOR A DOCTOR IMMEDIATELY.



Please read the manual carefully and retain it for future reference.

IMPORTANT!

1. All the illustrations serve the visualization and specification of the product. If you notice differences between the illustration and the product, follow the construction of the product.
2. Technical modifications in whole or in part to increase the product quality are expressively reserved without prior notice.

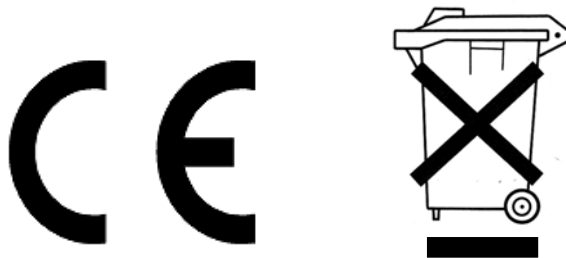

dubax-marketing oHG

WEEE-Reg.-Nr.: DE 33541416

Darmstadt / Germany

info@dubax-marketing.de

www.crooza.de

Our products are suitable for following standards:

CE, ASTM F963, GB6675, EN71 and EN62115

All rights reserved.

Copying, Performing and Distributing - **even in parts** - only with written consent of Dubax-Marketing oHG Darmstadt.

Copyright (©) by dubax marketing oHG Darmstadt / Germany.